

INVERTED BUCKET STEAM TRAP



S881



S881F

Application

Inverted bucket traps are the most robust type of the mechanical traps and will resist water hammer. When the check valve option has been fitted in the inlet, they can be used with superheated steam. They are available with a wide selection of valve orifices for precise pressure and load matching.

Size and pipe connections

DN15 - DN25 Screwed BSP or NPT

Material

Part	Material
Body/ Cover	GGG40/ A216 WCB/ A351 CF8
Cover bolts	A193 B7
Cover gasket	Graphite + SS304 or SS316
Valve seat	A276 430
Bucket and lever	A240 304
Strainer	A240 304

Note: 1.The material can according to the customer's request of actual valve working condition.

2.The surface of valve can use high temperature resistant black of blue paint, but also can according to the customer's request.

Installation

Horizontal connections with flow from right to left

Horizontal connections with flow from left to right

Limited condition

Body design conditions

PMA maximum allowable pressure

TMA maximum allowable temperature

Maximum differential pressure (ΔPMX)

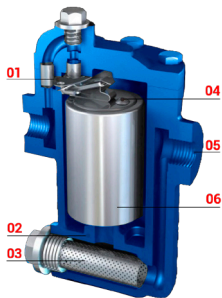

01.The valve core and seat have longer service life by hardening treatment

02.The valve is equipped with a water seal tube to reduce the leakage of steam

03.It have a filter screen inside the valve is resistant dirt and scale to protect the seat

04.Small amounts of air will pass thru the bleed hole on top of the bucket and be discharged

05.The entrance installtion check valve can be used for the superheated steam system.

06.The bucket is resistant to water hammer



- 1.Body GGG40/ A216 WCB/ A351 CF8
- 2.Cover GGG40/ A216 WCB/ A351 CF8
- 3.Plug ASTM A105
- 4.Cover bolt A193 B7
- 5.Conduit A276 304
- 6.Stem A276 304
- 7.Stem bolt A194 B8
- 8.Seat A276 430
- 9.Spool A276 430
- 10.Linkage A276 304
- 11.Fixed plate A240 304
- 12.Bucket A240 304
- 13.Filter A240 304
- 14.Bottom cap ASTM A105

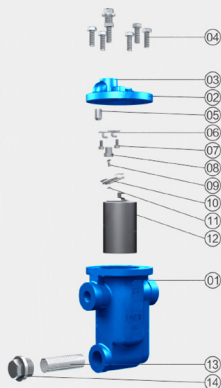

Capacities

S881/ S881F DN15 ~ DN25

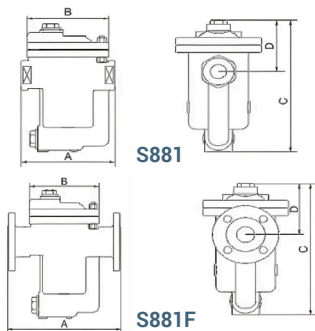
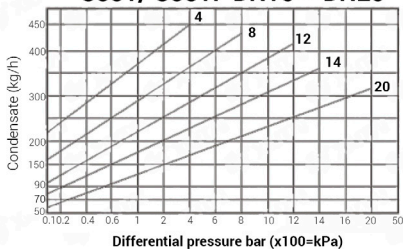

Dimensions/ weight

(approximate) in mm and kg

Screwed connections

S881					
Size	A	B	C	D	Weight
DN15	127	103	180	102	2.7
DN20	127	103	180	102	2.7
DN25	127	103	180	102	2.7

Dimensions/ weight

(approximate) in mm and kg

Flanged connections

S881F					
Size	A	B	C	D	Weight
DN15	170	103	180	102	3.9
DN20	170	103	180	102	4.1
DN25	170	103	180	102	4.6



SON Industrial

SON INDUSTRIAL COMPANY LIMITED
22A, TA13 Str, Thai An Ward, Dist 12, HCMC
admin@sonindustrial.com

